

137-166

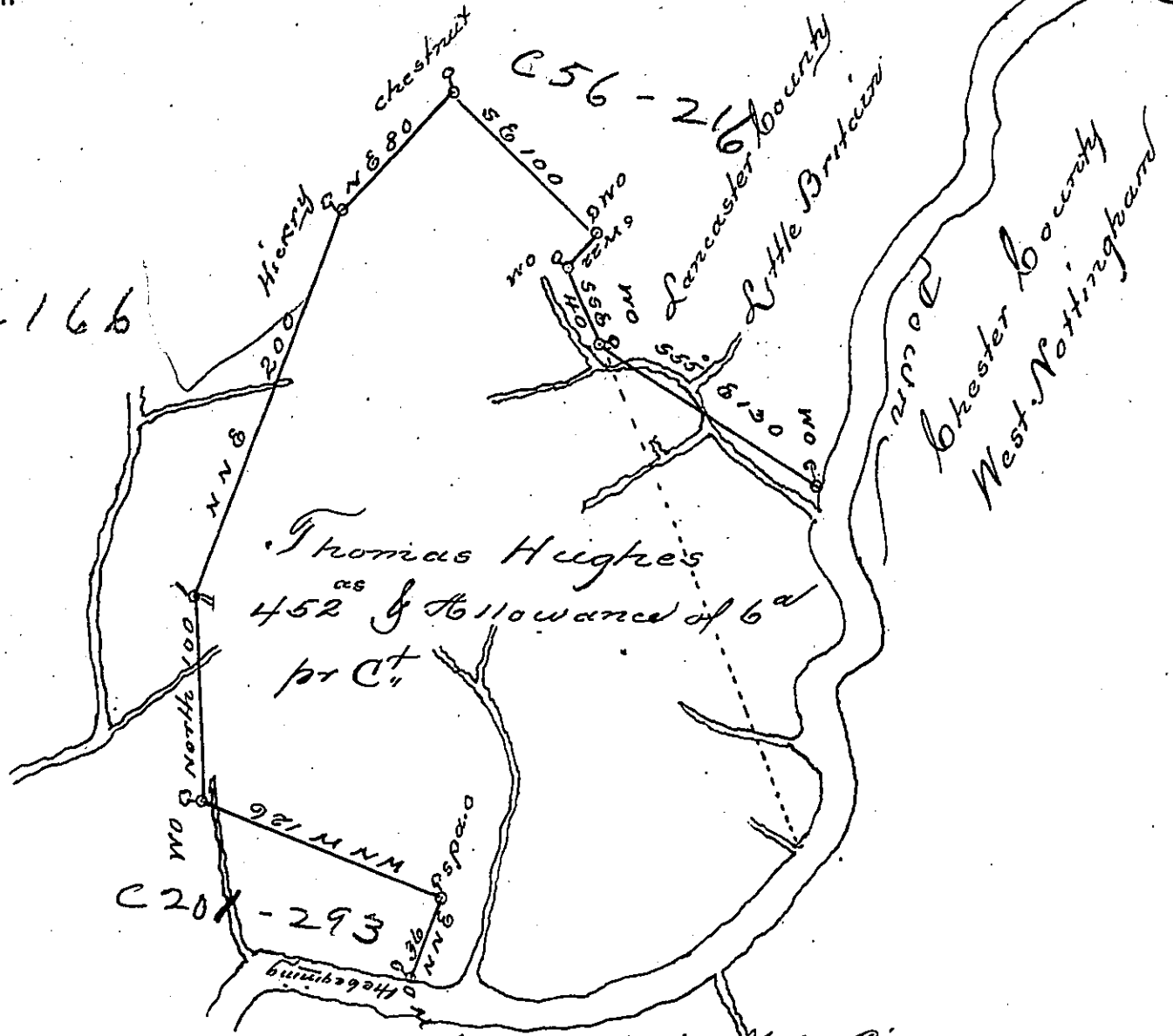

The bounds in right of Josiah Paine from the Proprietaries

By Virtue of a Warrant to me directed bearing date October 3rd 1741. Survey'd unto Thomas Hughes on 4th day of the 3rd mo: 1742. a tract of land Situate in y^e Township of Little Britain - & County of Lancaster. Beginning at a Corner white Oak standing by y^e side of Octoraro - on Lancaster shore opposite to Thomas Coulson's land. Running thence NNE 36 perches to a Spanish Oak Sapling thence WNW 126 perches to a White Oak, thence North 100 perches to a post, thence NNW 200 perches to a Hickory, thence North East 80 perches to a chestnut, thence South East 100 perches to a White Oak, thence South west 22 perches to a White Oak, thence S.S.E. 40 perches to a White Oak, thence South 55 degrees Easterly - Down a small Branch to a white oak Corner Stand - thence by y^e several courses of y^e break to y^e Beginning on y^e bank of Octoraro about 4 perches Northward of y^e mouth of y^e branch aforesaid, containing Four hundred & fifty two acres & y^e allowance of six acres per hundred for Roads &c.

Jno. Churchman

N.B. that small piece described by y^e prick line was an addition made to y^e first survey at the request of y^e heirs of Tho. Hughes on 4th 29th of y^e first month A.D. 1746.
 Due 6th 6. now for per J. B.

IN TESTIMONY that the above is a copy of the original remaining on file in the Department of Internal Affairs of Pennsylvania, made conformably to an Act of Assembly approved the 16th day of February, 1833, I have hereunto set my Hand and caused the Seal of said Department to be affixed at Harrisburg, this eighth day of March 1905

George D. Brown
 Secretary of Internal Affairs.